

STAR ISOFIX



UN ECE R44.04



*— ISOFIX. In Group I, installation of the child car seat without ISOFIX is FORBIDDEN!

NOTICE: This is a "Universal" child restraint. It is approved according to Regulation No. 44, O4 series of amendments, for general use in vehicles. It will fit most, but not all, car seats.

A correct fit is likely if the vehicle manufacturer has declared in the vehicle handbook that the vehicle is capable of accepting a "Universal" child restraint, for this age group.

This child restraint has been classified as "Universal", under more stringent conditions than those which applied to earlier designs, which do not carry this notice.

If in doubt, consult either the child restraint manufacturer, or the retailer.

This child restraint is only suitable for use in approved vehicles equipped with 3-point/static/with retractor safety belts, approved in compliance with UNECE R16 or other equivalent standards.

1. This system is the ISOFIX CHILD RESTRAINT SYSTEM. It is approved according to Regulation No. 44, O4 series of amendments, for general use in vehicles equipped with ISOFIX anchoring systems.

2. It is installed in the vehicles in the positions approved as ISOFIX positions (as detailed in the vehicle owner's manuals), depending on the category of the child car seat and the anchor.

3. The weight group and the ISOFIX size class, for which the child restraint is intended, are the following: Group I, ISOFIX class B1.

Please keep the child car seat installation manual during the lifetime of the device.

IMPORTANT!

Please observe the following safety notes:

1. Strictly follow the installation manual provided by the child restraint manufacturer. Read it carefully before using it for the first time.
2. Safety can only be ensured if the booster seat is installed correctly in accordance with the instructions described in this manual.
3. Do not use the child restraint without the cover.
4. Replace the seat cover only with the one recommended by the manufacturer, because the cover is an integral part of the safety system.
5. Do not use any load-bearing contact points, other than those described in the instructions, and marked on the child restraint.
6. Do not drive the car with your child unbelted in the booster seat. Remember that most car accidents occur on short-distance trips, or close to home.
7. Do not leave your child unattended in the child restraint.
8. Always ensure that the booster seat is secured in the vehicle, even when not in use.
9. Do not use the child restraint if it has been violently impacted by a car accident.
10. Any luggage or loose objects that can cause injury in the event of an accident must be secured in the car.
11. The hard items and the plastic parts of the booster seat must be located and installed properly during everyday use of the vehicle, to avoid being trapped by a movable seat, or by a vehicle door.
12. Protect the uncovered parts of the seat against direct sunlight, as they can become extremely hot, and harm your child's skin.
13. Any alterations or additions to this child restraint without the consent of a competent authority, as well as not closely following the installation manual provided by the booster seat manufacturer are **DANGEROUS!**
14. All parts of the seat can be cleaned with gentle cleaners. The seat cover can be washed at 30° C.
15. If you have any questions or doubts concerning the use of your booster seat, please consult the manufacturer.
16. Warm up the car interior, before placing your child into the car seat. It will increase the safety of your child restraint.
17. You should take off your child's bulky overclothes before securing him/her in the child restraint. Do not exceed the weight limit of your booster seat group.

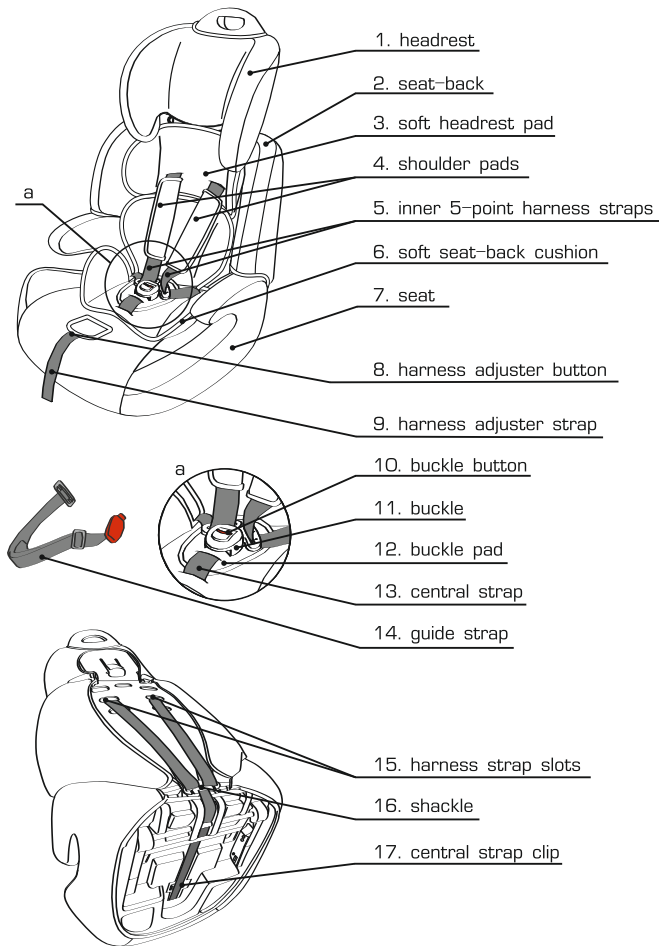

Some parts of the child car seat may differ from those given in this manual, as the manufacturer may make minor modifications and improvements.

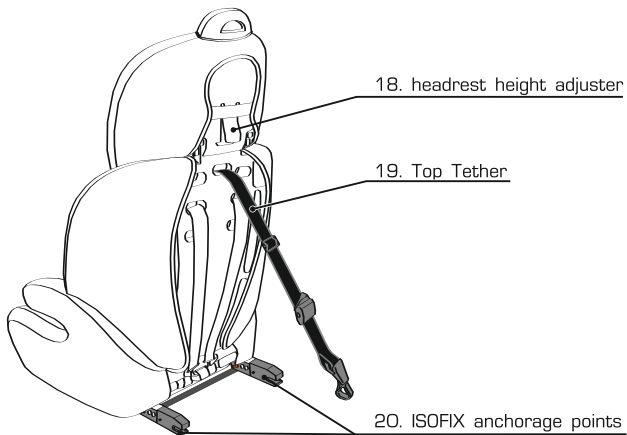

ISOFIX anchor transport position (ref. par.1.3)

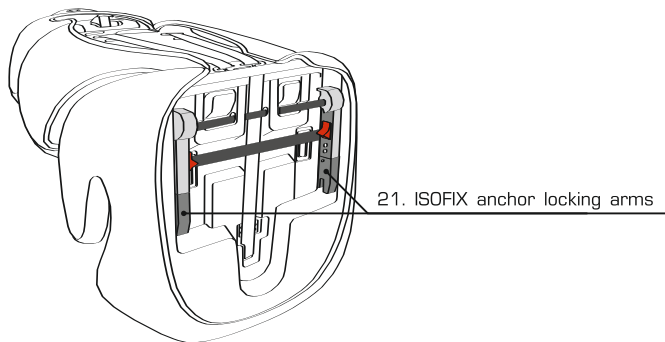

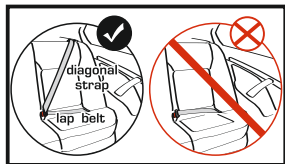

The child restraint must be installed on a vehicle seat equipped with 3-point seat belts and the ISOFIX anchoring system.

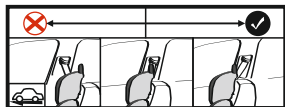

To install using a vehicle 3-point passenger seat belt, you must check that the upper point of the seat belt anchor is on the same level as the child car seat, or behind it.

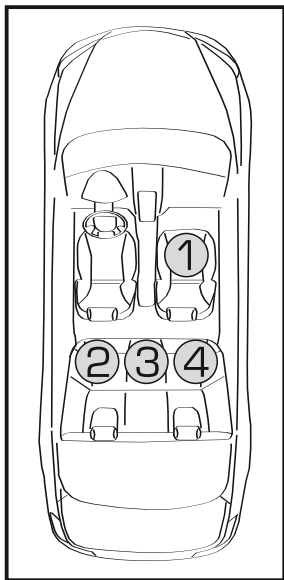

● Installation of the child car seat in the vehicle:

1,2,3,4 - forward-facing installation only.

1 - if the car has a front passenger airbag, turn it off. Then slide the vehicle seat backwards, to fix the upper point of the vehicle 3-point seat belt anchor on the same level as the child car seat, or behind it.



Follow the child car seat installation instructions specified in the owner's manual for your vehicle.

GROUP I (from 9 to 18 kg)

1.1 Headrest height adjustment.

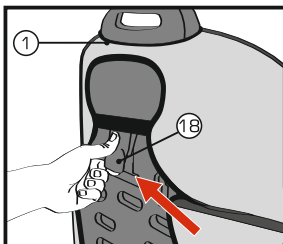

The child's shoulders should not bump into the headrest.

- To adjust the headrest (1) height, pull the adjuster 18 and move the headrest up or down.

The headrest can be fixed in four positions.

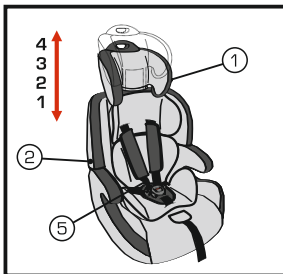

1.2 Inner 5-Point Harness Adjustment.

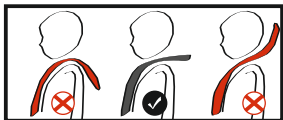

The correct position of the shoulder harness straps is on the level of the child's neck.

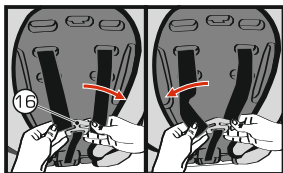

- Before installing the child car seat, adjust the height of the shoulder harness straps of the inner 5-point harness (5).

Take the shoulder harness straps off the shackle (16), and then pull them from the front of the seat back to remove them.

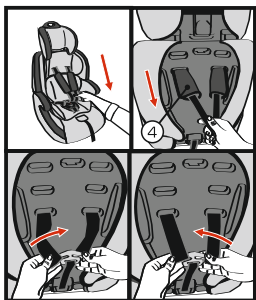

Remove the shoulder pads (4) from the rear part of the seat back.

Shift the shoulder harness straps and the shoulder pads (4) to the appropriate slots in the seat back.

Put the shoulder harness straps on the shackle (16).

- The guide strap (14) must be removed (ref. par. 3.2).

1.3 Child Car Seat Installation.



- Before installing the child car seat, make sure that the chosen vehicle seat has the ISOFIX anchorage system, which consists of two lower anchorage points and the Top Tether (an additional upper point of anchorage).

 Information on the availability and location of ISOFIX and Top Tether anchorage points is given in the owner's manual for your vehicle.

- If the Top Tether is removed, install it to its proper location (refer to the figure below).

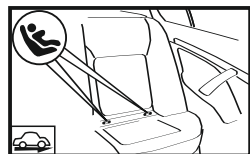

- The ISOFIX lower anchors are the two anchorage points on the vehicle seat (in the joint between the seat back and the seat cushion).

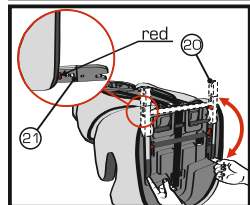

- To install the child car seat, unfold the ISOFIX anchor (20) from the transport position, by pulling it by both locking arms (21) out of the lock. Make sure that the indicators located on the outer lateral sides of the locking arms light up in red.

If not, push the red button located on the inner side of the locking arm (21), and the indicator must turn red.

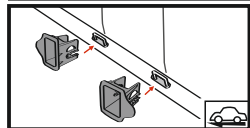

- Install the special insertion guides (if included in the package) on the ISOFIX anchorage points located in the vehicle. These insertion guides facilitate the child car seat installation.

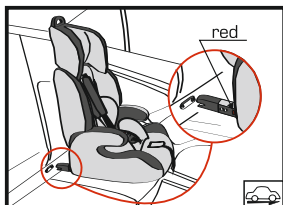

- Place the child car seat on the vehicle seat, positioning the locking arms right in front of the ISOFIX anchorage points (insertion aids).

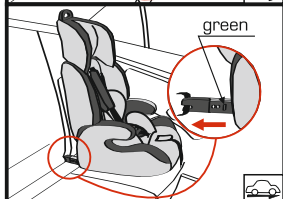

- Push the child car seat towards the seat back, until it clicks into place. Check that the indicators located on the outer lateral sides of the locking arms change color from red to green.

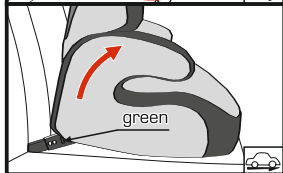

- If you can not see the indicators behind the soft vehicle seat cover, or the child car seat cover (and in other cases), slightly raise the child car seat.



Pull the child car seat from the seat back, then swing it to the left, and to the right. It must stay securely in its position.

 Installation of the child car seat using the ISOFIX anchoring system, without fastening the seat with the Top Tether, is forbidden!

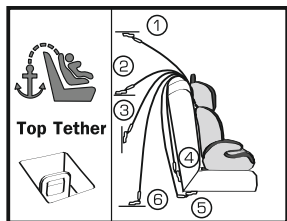

- The Top Tether anchor (19) is an additional (third) point of anchorage in the vehicle. As a rule, it is a metal attachment point in the form of an eyelet or bracket, marked with a special sign.

In different vehicles this anchor can be located in the following places:

- 1 – on the ceiling behind the seat back;
- 2 – on the rear shelf (for sedans);
- 3 – on the back wall (for pickups);
- 4,5 – on the vehicle seat;
- 6 – on the cargo area floor (for station wagons, SUVs, hatchbacks and minibuses).

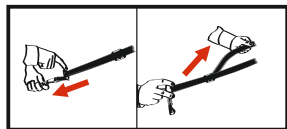

- Adjust the length of the Top Tether strap in advance:
 - to increase the length, slightly raise the ring clamp of the length adjuster, and pull the strap, where the snap hook is located;
 - to reduce the length – pull the free strap end.

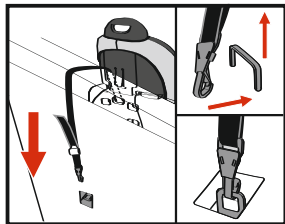

- Fix the Top Tether (19) at the anchorage point.

Open the snap hook, by pushing the spring clip. Attach the snap hook to the anchorage point. Do not twist the belt.

Check for looseness.

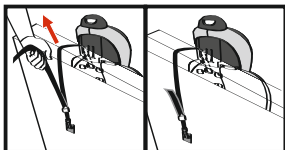

- Tighten the belt by pulling the free strap end.

- Make sure that the place of the Top Tether anchorage point corresponds to the place where the child car seat is installed.

The child car seat is now fastened!

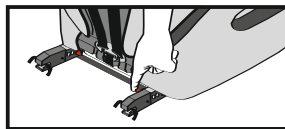

- To remove the child car seat from the vehicle seat:
 - unfasten the Top Tether (19) from the anchor point in the vehicle;
 - push the red buttons located on the inner lateral parts of the locking arms (21), and unlock the ISOFIX anchors (20).



For Groups II (from 15 to 25 kg) and III (from 22 to 36 kg) you can use only the ISOFIX lower anchors, and only as an additional function to secure the child car seat, and to prevent it from becoming loose. In this case your child should wear a seat belt.

1.4 Placing the Child in the Child Car Seat.

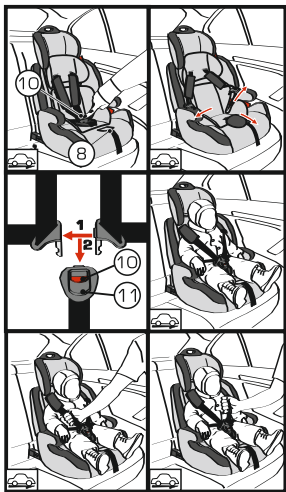

- To loosen the inner 5-point harness of the child car seat, push the harness adjuster button (8), and pull the harness straps (5).

DO NOT pull by the shoulder pads (4)!

Make sure that the child car seat is free of toys, or other foreign objects, and that it fits the vehicle seat-back tightly.

- Put the harness straps to the left and to the right, put the central strap (13) with the buckle (11) forward. Place the child onto the child car seat.

Put the harness straps on the child's shoulders, and secure the buckle (11) by joining the left and the right buckle tongues, inserting them into the buckle lock, until they click into place.

- Pull the harness adjuster strap (9), until the inner 5-point harness straps (5) are in an optimal position.



We recommend leaving some space that corresponds to the thick of a palm between the shoulder harness straps and the child's chest.

 The lap harness straps must be adjusted as low as possible across the pelvis, and not on the child's belly.

 The straps must be tightly adjusted, and not twisted.

- To release the child, push the red buckle button (10), pull the buckle tongues out and separate them. Take your child out of the seat.

GROUP II (from 15 to 25 kg)

2.1 Inner 5-Point Harness Removal.

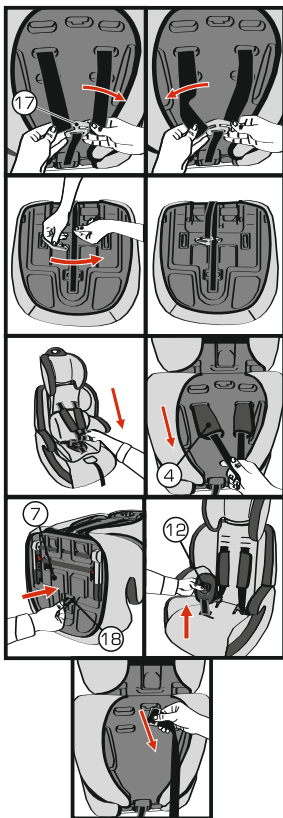

- Remove the inner 5-point harness (5):
Take the shoulder harness straps off the shackle (16).
- To fasten the harness adjuster strap (9), push the harness adjuster button (8), loosen the harness adjuster strap (9) and hook it to the shackle (16.)
Tighten the harness adjuster strap (9).
- Pull the shoulder harness straps and remove them from the slots of the seat-back, from the eyelets of the buckle (11), and from the seat (7).
Remove the soft headrest pad (3) and the soft seat-back cushion (6).
Remove the shoulder strap pads (4) from the rear part of the seat-back.
- To remove the central strap (13), push the clip (17) endwise into the slot on the bottom of the seat (7), and pull the buckle pad (12).
Installation of the central strap (13) is carried out in the reverse order.
- The Top Tether must be removed.

2.2 Child Car Seat Installation and Buckling in Your Child.



- Place the child car seat on the vehicle seat facing forward.

Make sure that the child car seat is free of toys, or other foreign objects, and that it fits the vehicle seat-back tightly.



All insertion points for the vehicle seat belts are marked in red on the child car seat.

Pass the lap belt of the vehicle 3-point passenger seat belt through the armrest, and direct the diagonal strap through the slot in the headrest (1).

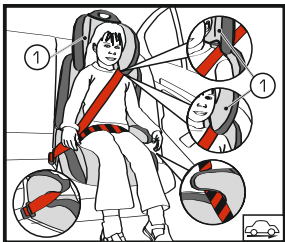

- Place the child into the child car seat, and fasten him/her with a vehicle 3-point passenger seat belt. The lower part of the diagonal strap and the lap belt must run under the armrest of the seat.



Make sure that the vehicle seat belt buckle is not fixed too high, and is not bumping against the armrest of the child car seat. Otherwise, use another vehicle seat to install the child car seat. If in doubt, please consult the child car seat manufacturer.



The lap belt must be adjusted as low as possible across the pelvis, and not on the child's belly.



The diagonal strap of the seat belt **MUST NOT** run across the child's neck!



The seat belt must be tightly adjusted. Do not twist the seat belt.

- To release the child, unfasten the seat belt as normal.

GROUP III (from 22 to 36 kg)

3.1 Seat-back Removal.

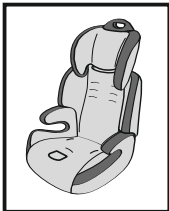

- Remove the inner 5-point harness and the Top Tether, before removing the seat back (ref. par. 2.1).

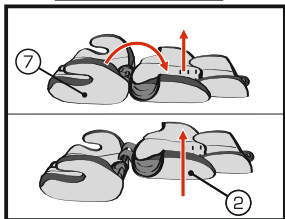

- Tilt the seat back (2) backwards, and unfold it.
- Making an effort, pull the seat-back anchors out of the grooves in the seat.

3.2 Booster Seat Installation and Buckling in Your Child.



- Place the booster seat on the vehicle seat facing forward.

Make sure that the booster seat is free of toys, or other foreign objects, and that it fits the vehicle seat-back tightly.



All insertion points for the vehicle seat belts are marked in red on the booster seat.

- Pass the lap belt of the vehicle 3-point passenger seat belt through the armrest.



- Place the child into the booster seat, and fasten him/her with a vehicle 3-point passenger seat belt. The upper part of the diagonal strap must rest on the child's shoulder. The lower part of the diagonal strap must be under the armrest, with the lap belt running under both armrests of the booster seat.

If the diagonal strap of the vehicle 3-point passenger seat belt runs across the child's neck, install the guide strap on the side of the child's shoulder, where the upper part of the diagonal strap of the vehicle seat belt runs.

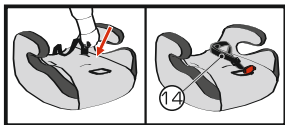

- To install the guide strap (14), push the clip through the corresponding slot in the cover, and then into the slot in the seat. Turn it sideways to fasten it.

Pass the guide strap behind the child's back, and adjust the height.

Use the plastic clamp on the guide strap to fasten the diagonal strap to the vehicle's 3-point passenger seat belt, just over the child's shoulder.

- The guide strap removal is carried out in reverse order.



Make sure that the vehicle seat belt buckle is not fixed too high, and is not bumping against the armrest of the booster seat. Otherwise, use another vehicle seat to install the booster seat. If in doubt, please consult the child car seat manufacturer.

 The lap belt must be adjusted as low as possible across the pelvis, and not on the child's belly.

 The diagonal strap of the seat belt **MUST NOT** run across the child's neck!

 The seat belt must be tightly adjusted. Do not twist the seat belt.

- To release the child, unfasten the seat belt as normal.

WASHING AND CLEANING



- Pull the edges and take off the headrest, the seat-back and the booster covers.

- After washing, put the covers on in reverse order.

Do not machine wash the cover. Do not use abrasive detergents. Water temperature should not exceed 30° C.

Clean the plastic parts with solvent-free and non-abrasive polish.



All passengers should know how to release the child from the child car seat, in the event of an accident.



To avoid injuring the child secured in the child car seat, in the event of an accident, make sure that all passengers in the vehicle have their seat belts appropriately fastened.

PLEASE KEEP THE WARRANTY CARD!

BABYlion